

NVR Quick Start Guide

EN

Welcome! Lets get started.

- **Getting to know your NVR**
- **What does this mean?**
- **Connect your Cameras**
- **Connect the NVR to your Home Network**
- **Connect the Mouse**
- **Connect the NVR to your HDTV**
- **Connect the NVR to your Monitor (optional)**
- **Connect the Power Adapters**

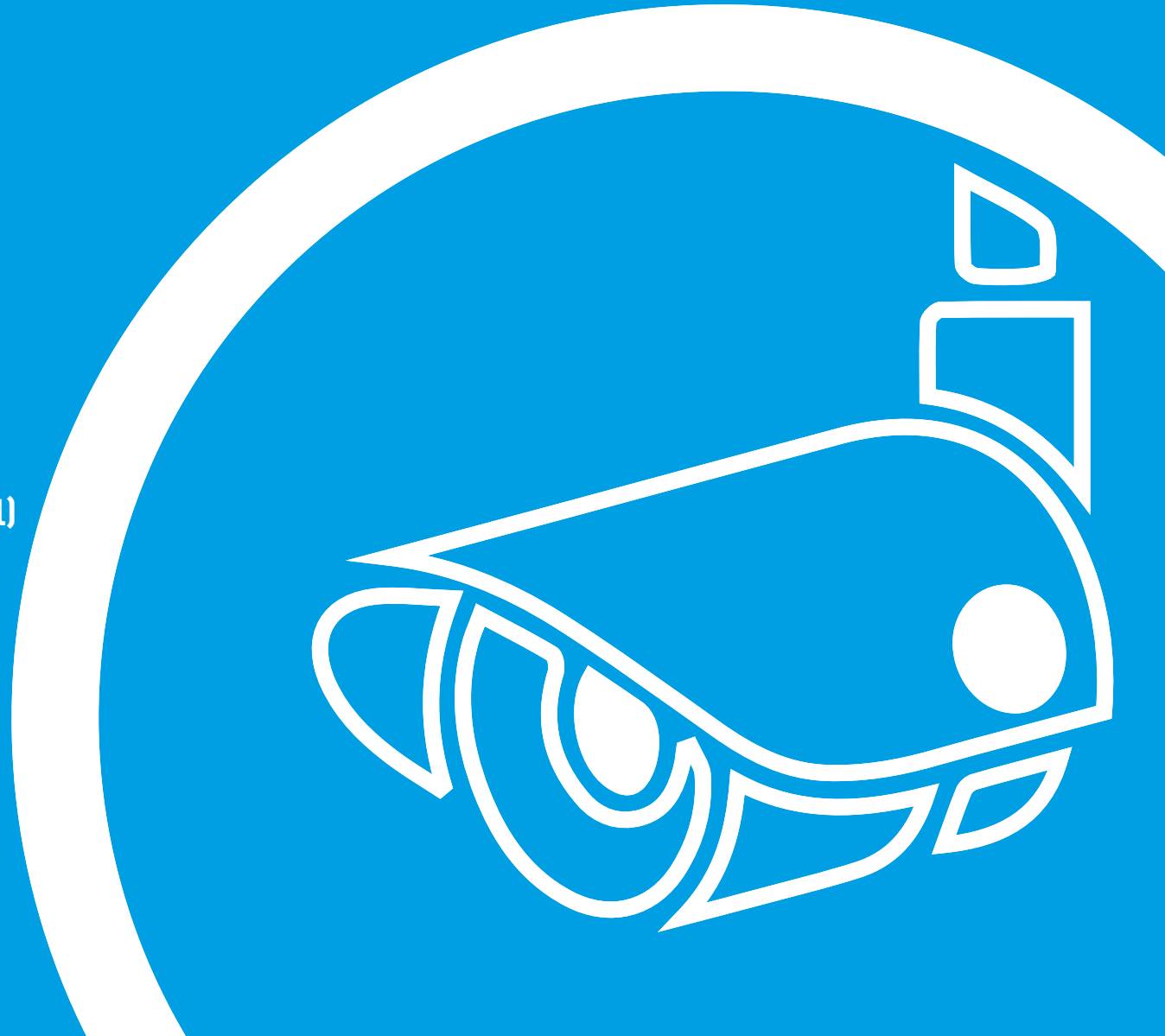

Getting to know your NVR

Congratulations on the purchase of your Swann NVR. This quick start guide will assist you on getting your NVR up and running as soon as possible. We recommend that you connect everything and give it a try before you do a permanent installation, to make sure nothing was damaged during shipping. On the other side is a detailed connection map which illustrates the various connections on the NVR.

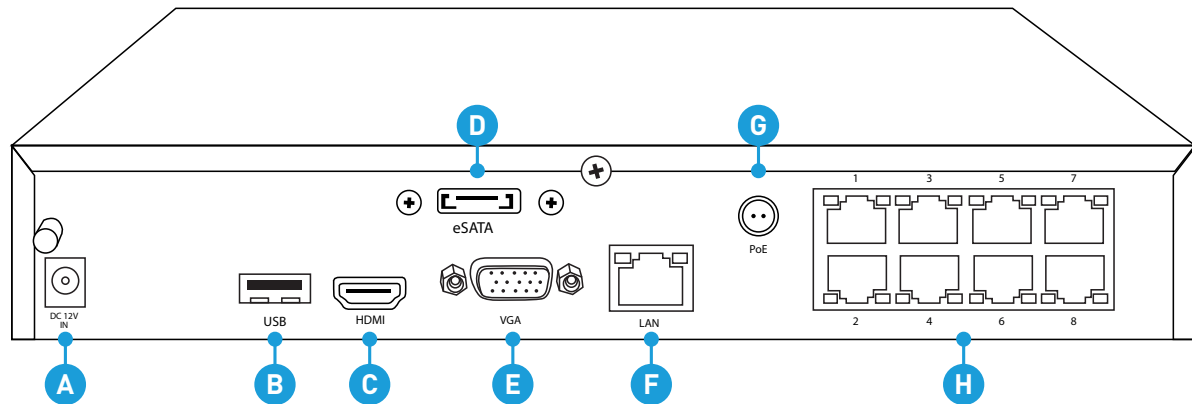

- A) Power
- B) USB
- C) HDMI
- D) eSATA
- E) VGA
- F) LAN

- G) PoE Power Socket
- H) Camera Inputs

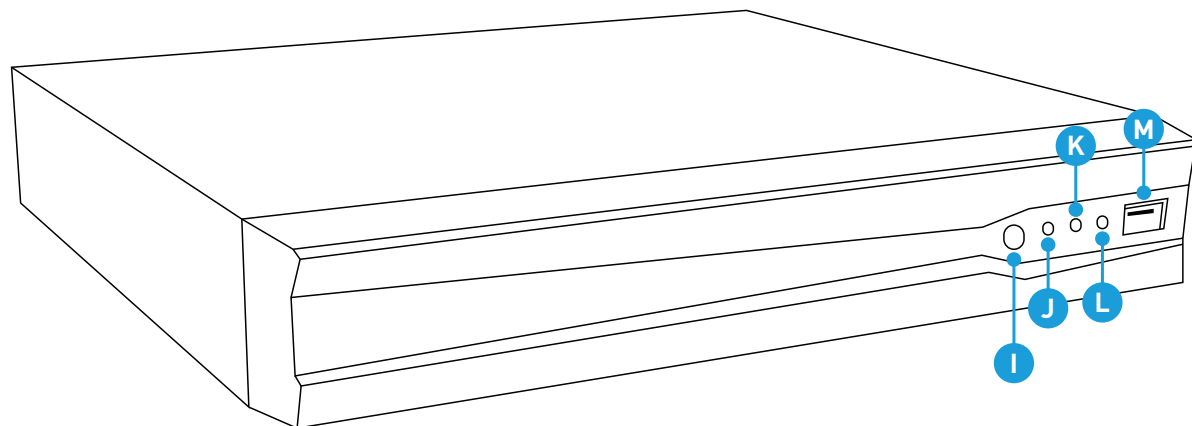

- I) IR Receiver
- J) Power LED
- K) Hard Drive LED
- L) LAN LED
- M) USB

What does this mean?

Here are explanations for the various connections and lights on the NVR -

A) Power - This is where you connect the power adapter.

B) USB - Connect the mouse here, able to connect a Flash Drive to backup recorded events.

C) HDMI - If you have a digital TV with HDMI input, connect this to an available input.

D) eSATA - An easy way to connect an additional Hard Drive for extra storage.

E) VGA - If you have a digital TV or a monitor with VGA input, connect this to an available input.

F) LAN - Connect this to your home network so your NVR can connect to the Internet.

G) PoE Power Socket - This is where the cameras get their power from.

H) Camera Inputs - This is where you plug in the camera cables.

I) IR Receiver - Receives a signal from the included remote control.

J) Power LED - When the NVR has power, this light will turn on.

K) HDD LED - This will flash when the hard drive is working.

L) LAN LED - This will flash when there is network activity.

M) USB - Connect the mouse here, able to connect a Flash Drive to backup recorded events.

Connect your Cameras

To connect your camera(s) to the NVR, simply connect the supplied Ethernet cable to the LAN connection on the camera then plug the other end of the Ethernet cable into one of the camera inputs on the back of the NVR. It doesn't really matter which port you use as they are quite versatile and will be configured in a later step. Please note; the Ethernet cable is the same at both ends so it doesn't matter which end plugs into the camera or NVR.

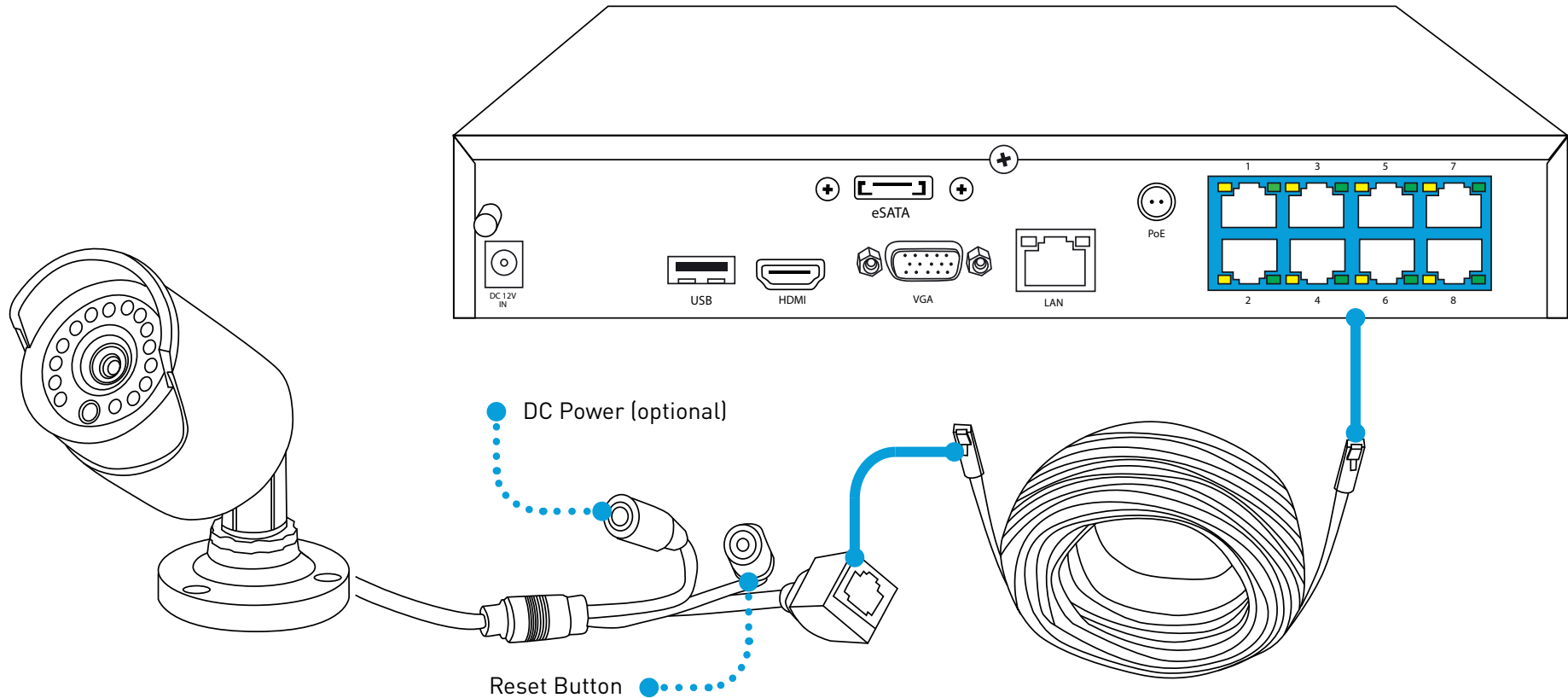

Connect the NVR to your Home Network

Connect the Ethernet cable (supplied) to the LAN connection on the NVR, and then connect the other end to a spare port on your router or wireless access point.

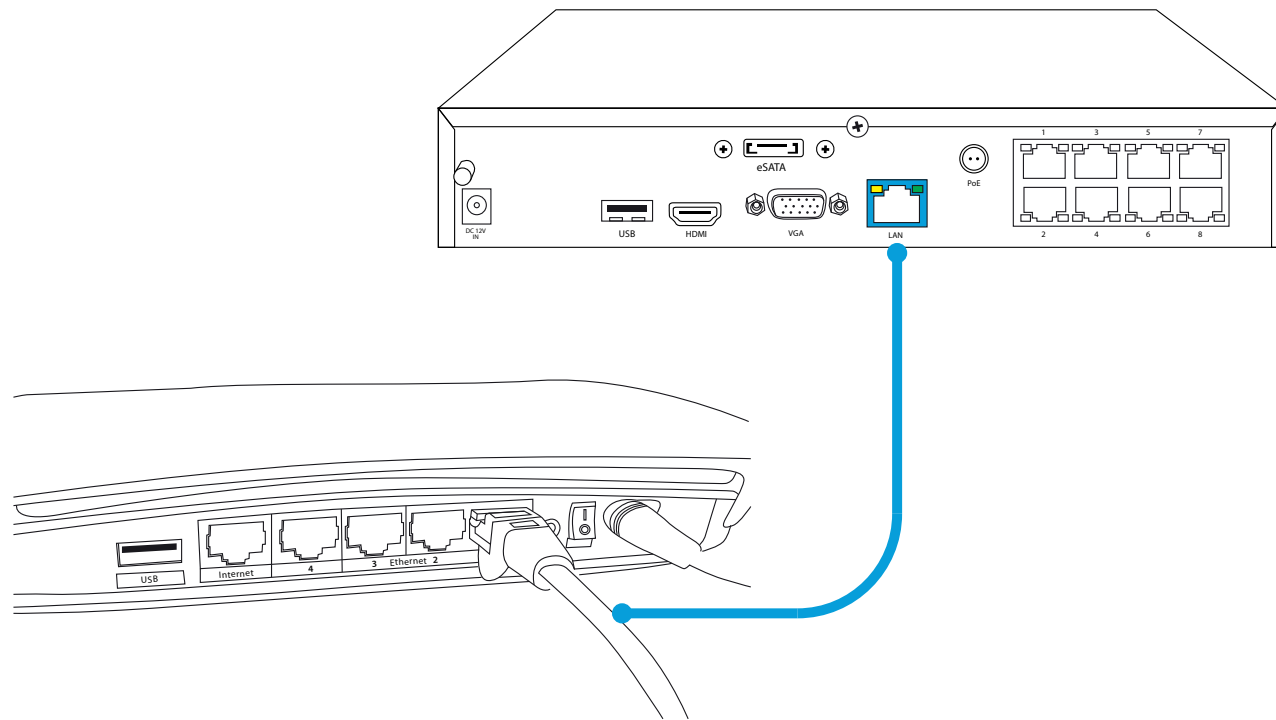

It's important that you do this, as this allows you to access the router from your smartphone or tablet. It also allows the NVR to connect to the Internet to update its internal clock so the time it shows on the video is always accurate, and to send you email notifications.

Connect the Mouse

Connect the mouse (supplied) to a spare USB port on the NVR.

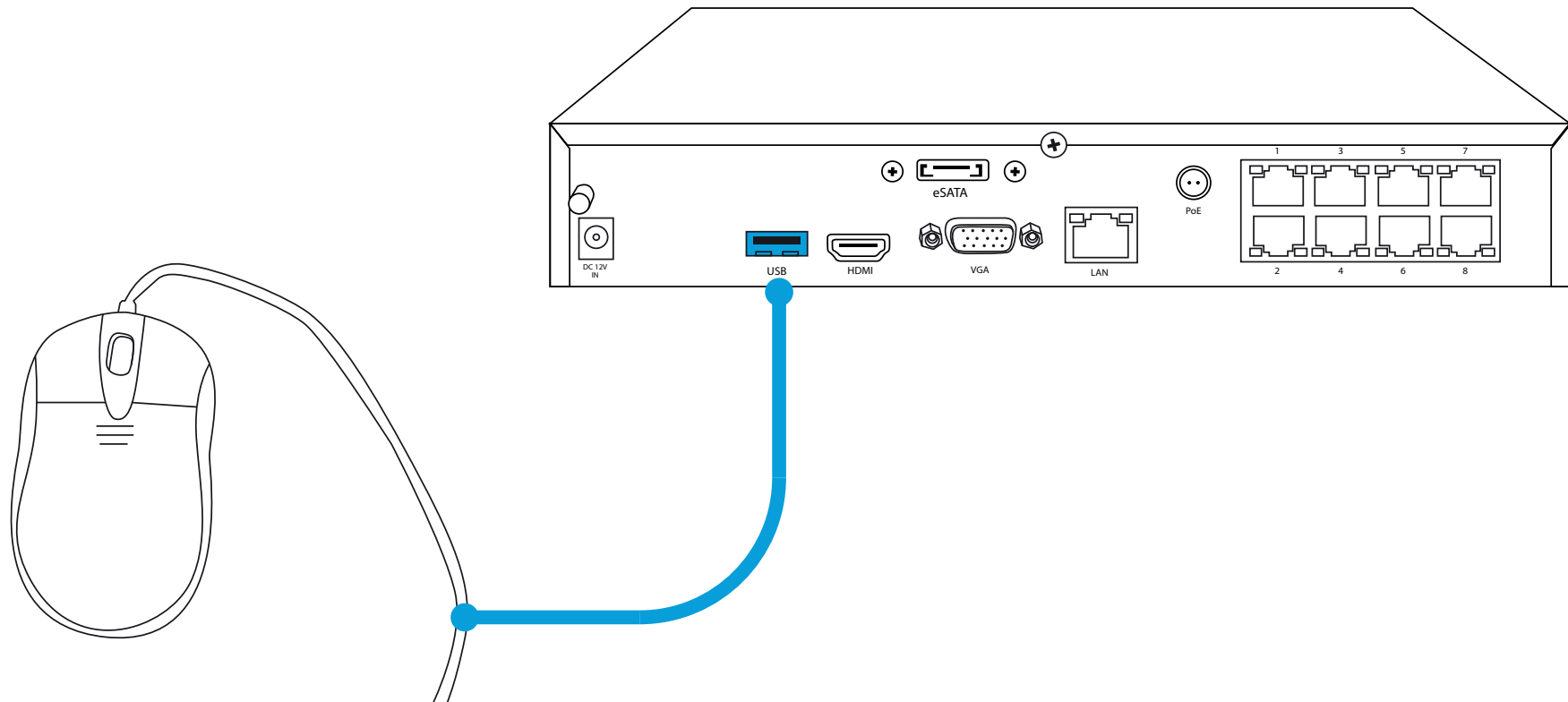

Connect the NVR to your HDTV

Connect the HDMI cable (supplied) to the HDMI input on the NVR, and connect the other end to a spare HDMI input on the TV.

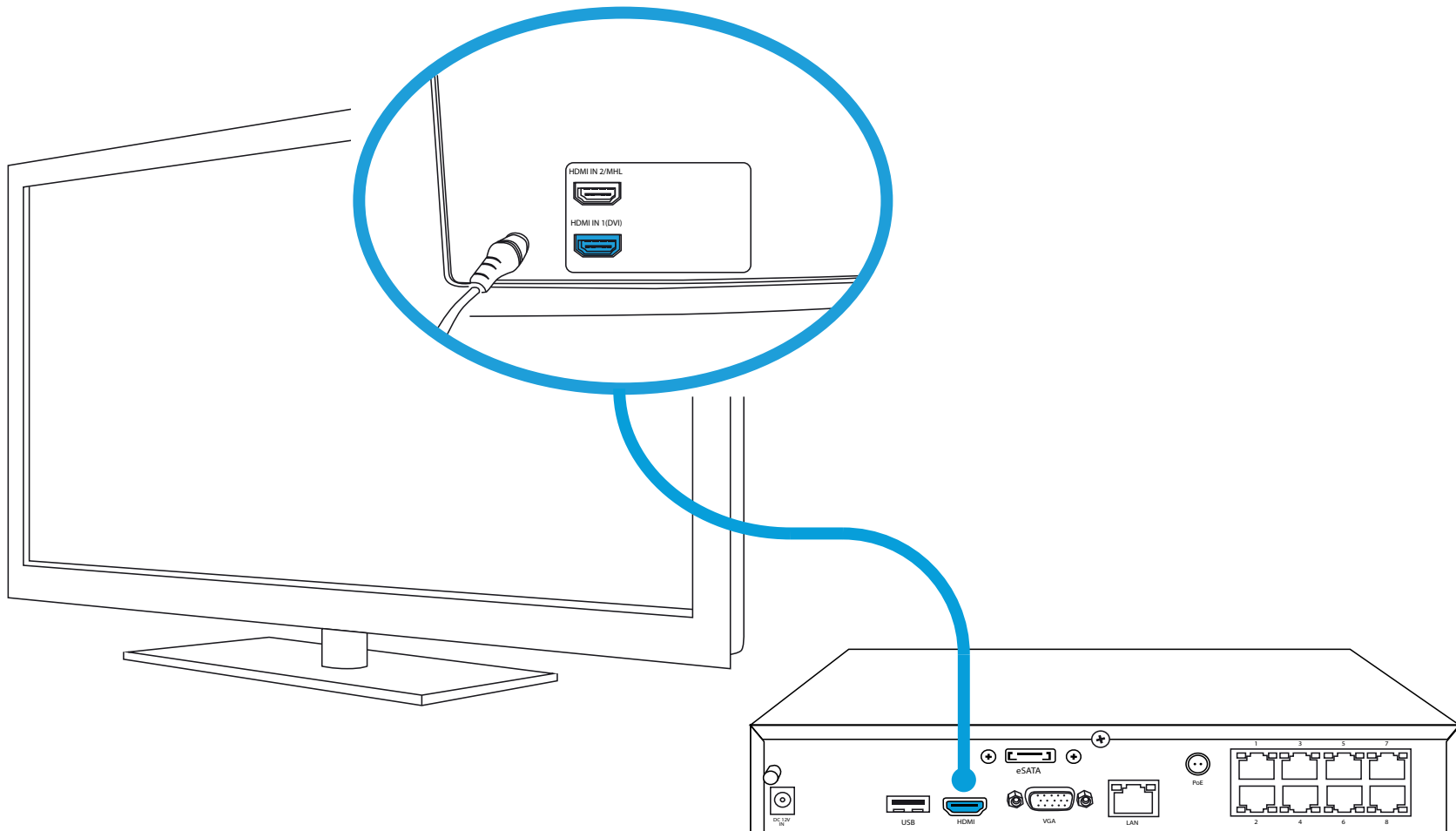

Connect the NVR to your Monitor (optional)

If you have a Monitor with a VGA connection, connect a VGA cable (not supplied) to the VGA output on the NVR, and connect the other end to the VGA input on the Monitor.

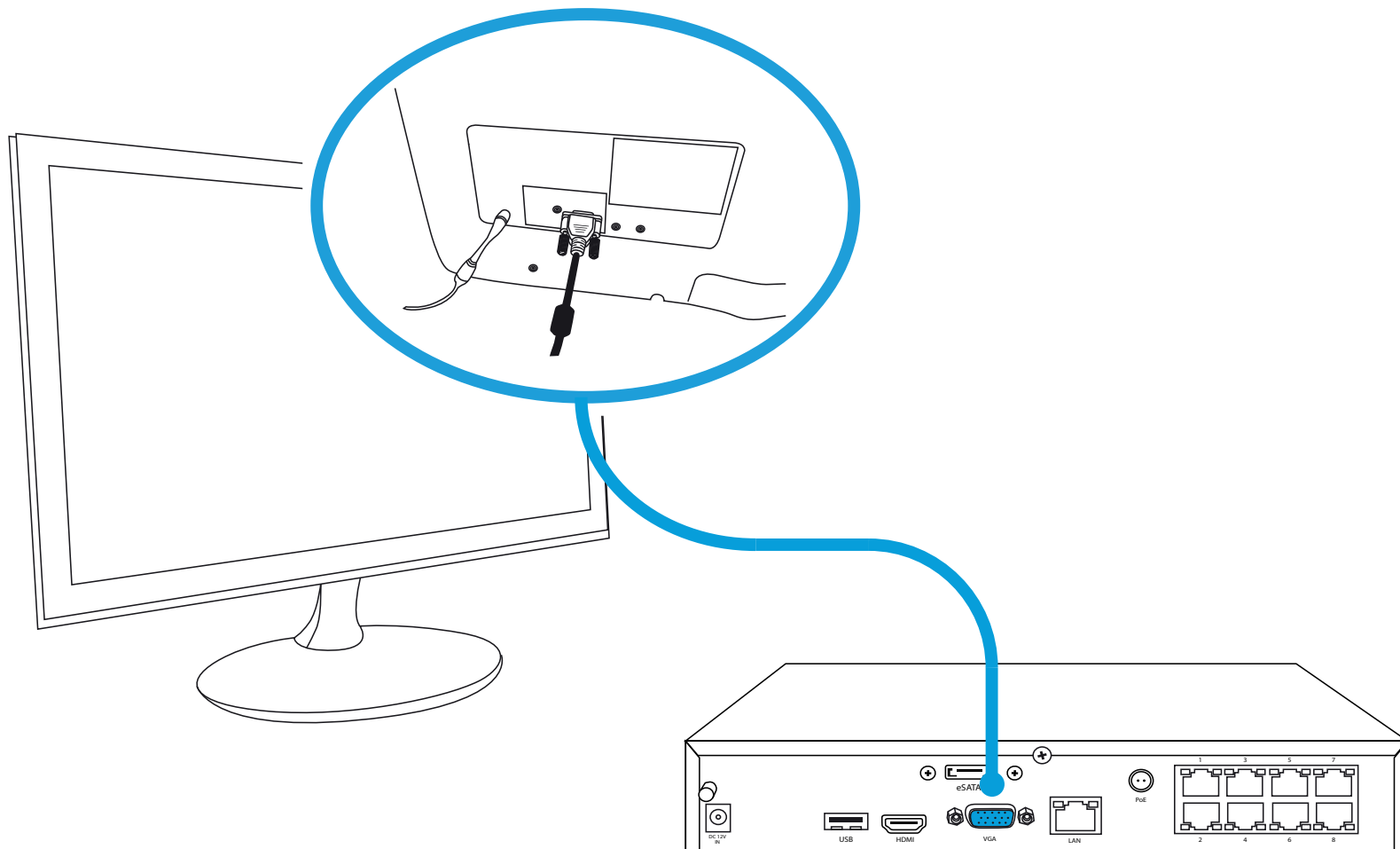

Connect the Power Adapters

Included are two power adapters. First connect the PoE power adapter to the PoE socket on the NVR so the cameras have power. Screw the small retention ring to ensure the plug doesn't fall out. To power the NVR connect the power adapter to the power input.

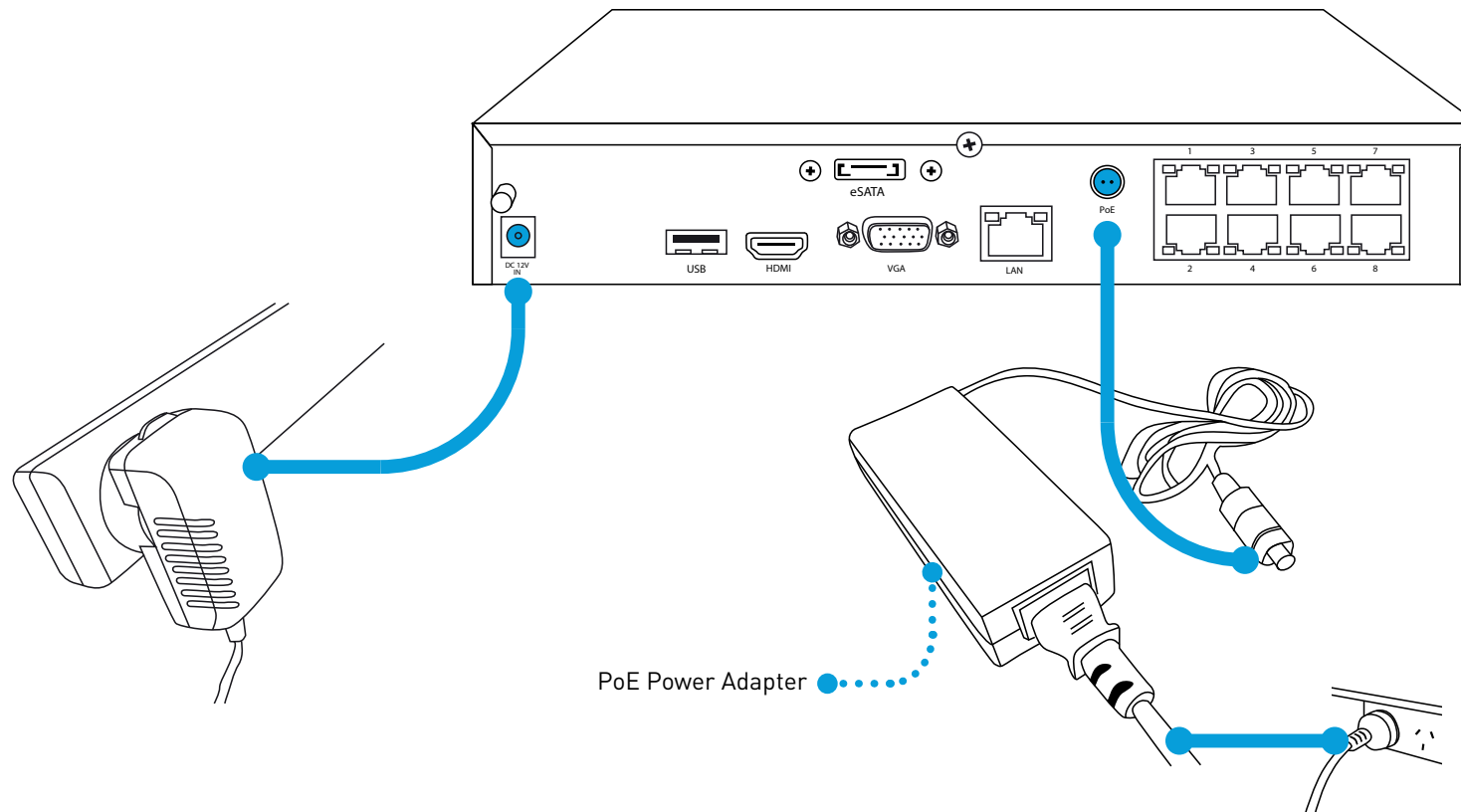

All connections have now been completed. You're now ready to run through "The Setup Wizard" to configure your NVR.